

Living better *Everyone's Dream*

Approved by



Green Park
Apartment



Living better *Everyone's Dream*

Approved by



2 BHK Luxury Apartments @ Nallapadu, Guntur.

Green Park
.....
Apartment

A Prestigious project from

ROYAL
INFRA

A Prestigious project from



Highlights

- Deluxe Quality
- 100% Vaasthu
- No common walls
- Elevation with good aesthetics
- Stilt Car Parking
- 24 hr Water Supply
- Quality material-Fine Finishing
- Safe and Secure Investment
- Termite Treated wood
- Power Back-up common area
- Very Experienced Builders
- Pollution free atmosphere
- 3 Phase Electrical Connection
- Electrical fittings all are **HAVELLS OR EQUIVALENT**
- Dedicated play area for children and Beautiful land scaping with in premises as gated community



Location Plan

Not To Scale

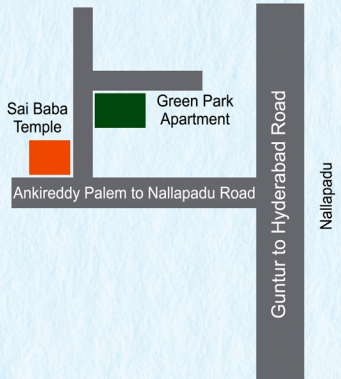

Approved project

Green Park
.....
A p a r t m e n t

TYPICAL FLOOR PLAN G+4

2 BHK Luxury Apartments @ Nallapadu, Guntur



30'-0" WIDE ROAD

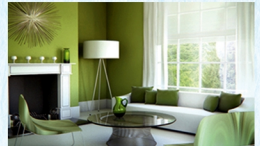
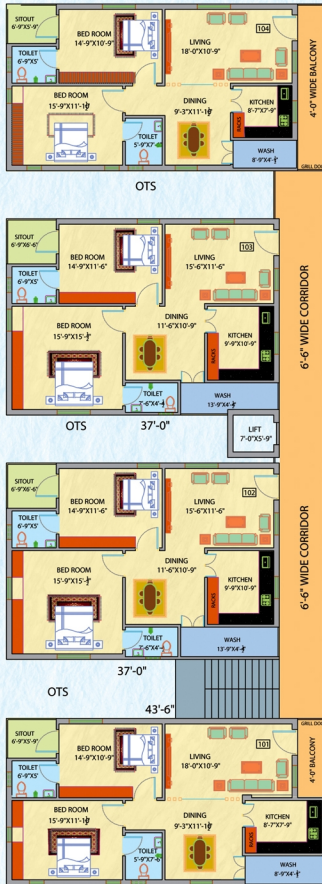

Green Park
Apartment

SPECIFICATIONS

FOUNDATION &

STRUCTURE : RCC Framed Structure with **M25** grade concrete.

WALLS : Outer walls 9" thick and inner walls 4.5" thick country red brick wall with CM.

PLASTING : Cement mortar and two coats of plastering with sponge finish inside and outside.

MAIN DOOR : **Sudhan** Teak wood frames with Teak wood paneled shutters and brass hinges are fittings.

OTHER DOORS : Teak wood frames with flush shutters and SS fittings

WINDOWS : Frames & shutters WPVC with glass & safety grills.

CUPBOARDS : Cupboards with both side laminated **Action Texa** with SS handels of nearly **30%** of plinth area.

CEALING : Cealing with **Gypsum (Gyproc)** including 6w lights.

FLOORING : 2' x 2' Double Charged Vitrified tiles flooring.

KITCHEN : Polished black granite platform with Stainless steel sink and 3' height digital tiles dadingo.

Bore & Municipal **ESSESS** water taps. Provision for cabinets.

ELECTRICAL : Concealed Havells or equivalent copper wiring of suitable guage with adequate light and power points.

Provision of socket for Telephone, Cable TV, Refrigerator, Mixer, Geyser with modular **Legrand** switches.

A/C point provision in Hall & Two bedrooms. Inverter wiring provision provided.

FANS & LIGHTS : **Havells**, Switches and MCP's **Legrand**

TOILETS : All toilets are with EWC **Paryware** company. Anti-skid ceramic tiles flooring **Appoxy** digital tiles dadingo up to door height (6'0") with standard make sanitary fittings and **ESSESS** Bath fittings.

PLUMBING : All water pipelines are with **CPVC Ashirvad** pipes. CERA / Equivalent make wash basin in dining area.

PAINTING : Internal - Plastering with cement mortar followed by **Birla** wall care followed by two coats of **Premium emulsion** of asian paints over a coat of primer.

External - Plastering with cement mortar followed by wall care and texture finish with **Asian ultima emulsion** of asian paint over a coat of primer.

EXTRAS : AP TRANSCO, Generator, Lift and Car parking.

NOTE : Registration charges, GST and any other taxes & Fees levied by the Govt. are extra and have to be borne by the purchaser.

Site Address

Green Park Apartment

Ankireddy Palem Road,
Nallapadu, Guntur - 522005.

ANDHRA PRADESH

ROYAL INFRA

Y.Ravi Kiran - 98485 19456

P.Khasim Khan **B.E** - 92464 83959

CH.Srinivas - 89786 95999

D.No.25-17-139, 12th Line,
Srinivasarao Peta, Guntur .

ANDHRA PRADESH

mail : khan.pandu@gmail.com

Architect



Sudheer Associates
Architects & Interior Designers
10/1 Arundelpet,
Guntur -2.
Ph.no :2352244 .

Email: Sudheerassociates9@gmail.com

Structural Engineer



MK CONSULTANTS

STRUCTURAL ENGINEERS I
D.No: 98-35, Main Road
Nagaram Palem, Guntur -522004.
Email: murali91r@gmail.com,
Mob: 965246959